



STEPHENSON BROWNE

**Hellyar-Brook Road,
Alsager**

ST7 2YL



£250,000

Description

A three bedroom detached family home in a cul-de-sac position within Alsager, requiring modernisation throughout but offering excellent potential!

A well-proportioned home which needs renovation, but has ample scope to be improved and could make a fantastic family home!

An entrance porch and hallway leads to the lounge, with a separate dining room leading to the kitchen, and a rear hallway accessing the downstairs W/C and providing integral access into the garage. Upstairs there are three bedrooms and the family bathroom, with the principal bedroom featuring an en-suite shower room and fitted wardrobes.

Off-road parking is provided via a tarmac driveway, whilst the rear garden features a lawn and shrubs, although does require some attention.

Hellyar-Brook Road is just off Dunnocksfold Road, with excellent access to commuting links such as the M6, A500 and A34, with Alsager train station also within easy reach. Several schools are nearby, including Alsager School and Cranberry Academy. Leisure facilities at Alsager Sports Hub and Alsager Leisure Centre are both within walking distance.

A spacious home which requires modernisation but offers excellent potential! Please contact Stephenson Browne to arrange your viewing.



Room Descriptions

Entrance Porch

Composite front door, timber framed single glazed windows, wall light point, timber door to;

Entrance Hall

Ceiling light point, radiator.

Lounge

13'10" x 11'7"

UPVC double glazed window, ceiling light point, radiator.

Dining Room

9'3" x 8'9"

UPVC double glazed patio doors, ceiling light point, radiator.

Kitchen

9'10" x 9'3"

Tiled flooring, UPVC double glazed window, ceiling strip light, radiator, under stairs storage cupboard, stainless steel sink with drainer, wall and base units.

Rear Hall

UPVC double glazed rear door, ceiling light point, tiled flooring, integral access to the garage.



Downstairs W/C

5'5" x 3'6"

Tiled flooring, UPVC double glazed window, ceiling light point, radiator, W/C, wash basin, tiled splashback.



Landing

Ceiling light point, radiator, loft access, airing cupboard.

Bedroom One

11'9" x 11'7"

UPVC double glazed window, ceiling light point, radiator, fitted wardrobes, storage cupboard.



En-Suite Shower Room

5'3" x 5'0"

UPVC double glazed window, ceiling light point, radiator, part tiled walls, W/C, pedestal wash basin, shower cubicle.

Bedroom Two

14'2" x 7'8"

Two timber framed single glazed windows, ceiling light point, radiator.



Bedroom Three

9'2" x 8'2"

Timber framed single glazed window, ceiling light point, radiator.



Bathroom

6'3" x 6'2"

Timber framed single glazed window, ceiling light point, radiator, part tiled walls, W/C, pedestal wash basin, bath with overhead shower.



Outside

To the front of the property is a lawned garden with border shrubs and a tarmac driveway. The rear garden is mostly laid to lawn with shrubs, requiring some attention.

Integral Garage

17'1" x 7'0"

Up and Over garage door, integral access into the rear hall, ceiling strip light, Baxi gas central heating boiler.

Council Tax Band

The council tax band for this property is D.

Freehold Tenure

We have been advised that the property tenure is Freehold. We would advise any potential purchasers to confirm this with a conveyancer prior to exchange of contracts.



NB: Copyright

The copyright of all details, photographs and floorplans remain the possession of Stephenson Browne.

Alsager AML Disclosure

Agents are required by law to conduct Anti-Money Laundering checks on all those buying a property. Stephenson Browne charge £49.99 plus VAT for an AML check per purchase transaction. This is a non-refundable fee. The charges cover the cost of obtaining relevant data, any manual checks that are required, and ongoing monitoring. This fee is payable in advance prior to the issuing of a memorandum of sale on the property you are seeking to buy.



Floorplans

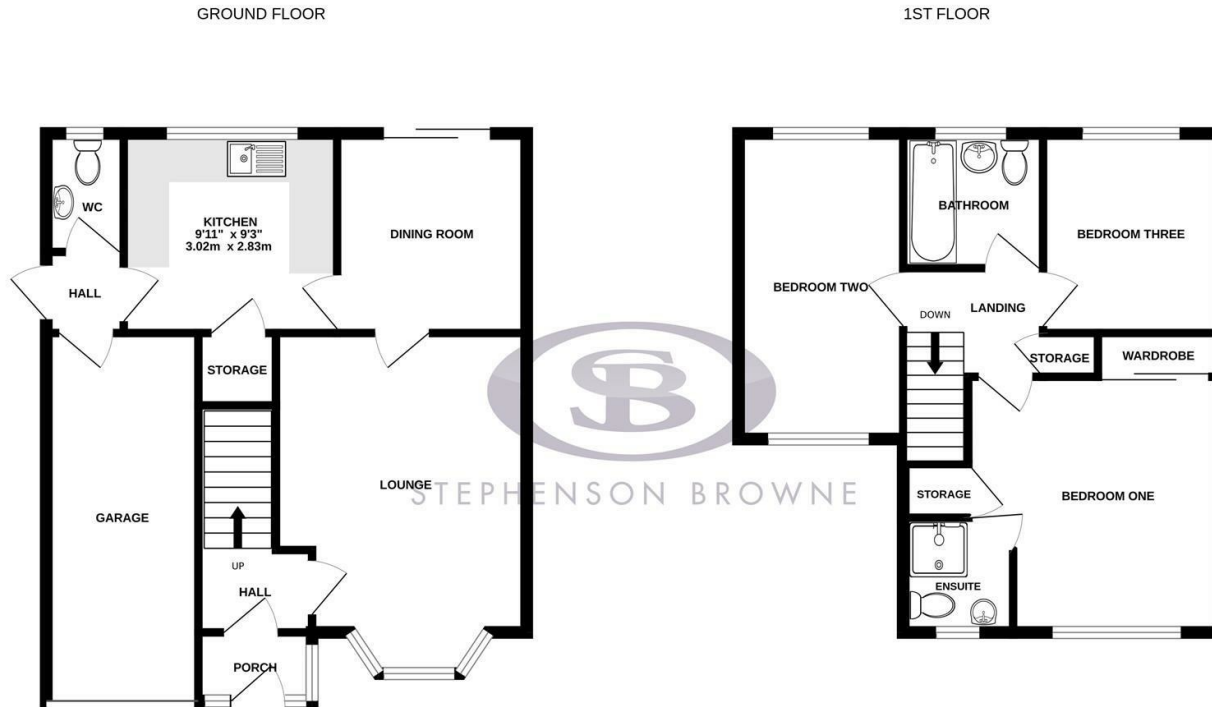

Whilst every attempt has been made to ensure the accuracy of the floorplan contained here, measurements of doors, windows, rooms and any other items are approximate and no responsibility is taken for any error, omission or mis-statement. This plan is for illustrative purposes only and should be used as such by any prospective purchaser. The services, systems and appliances shown have not been tested and no guarantee as to their operability or efficiency can be given.
Made with Metropix ©2026

Area Map



EPC Rating

Energy Efficiency Rating	Current	Potential
Very energy efficient - lower running costs		
(92 plus) A		
(81-91) B		
(69-80) C		
(55-68) D		
(39-54) E		
(21-38) F		
(1-20) G		
Not energy efficient - higher running costs		
England & Wales	EU Directive 2002/91/EC	

Environmental Impact (CO ₂) Rating	Current	Potential
Very environmentally friendly - lower CO ₂ emissions		
(92 plus) A		
(81-91) B		
(69-80) C		
(55-68) D		
(39-54) E		
(21-38) F		
(1-20) G		
Not environmentally friendly - higher CO ₂ emissions		
England & Wales	EU Directive 2002/91/EC	

Viewing

Please contact our office using the details provided at the bottom of this page if you are interested in booking a viewing or require further information.

NOTICE: Stephenson Browne for themselves and for the vendors or lessors of this property whose agents they are give notice that: (1) the particulars are set out as a general guideline only for the guidance of intending purchasers or lessees, and do not constitute, nor constitute part of, an offer or contract; (2) all descriptions, dimensions, references to condition and necessary permissions for use and occupation, and other details are given in good faith and are believed to be correct but any intending purchasers or tenants should not rely on them as statements or representations of fact but must satisfy themselves by inspection or otherwise as to the correctness of each theme; (3) no person in the employment of Stephenson Browne has any authority to make representation or warranty whatever in relation to this property. (4) fixtures & fittings are subject to a formal list supplied by the vendors solicitors. **Referring to: Move with Us Ltd Average Fee: £123.64**

T: 01270 883130 E: alsager@stephensonbrowne.co.uk

www.stephensonbrowne.co.uk